

Plasti-Fab®

PRODUCTS FOR THE WATER AND WASTEWATER INDUSTRY

**CIRCULAR
FLAP
GATES**
PRODUCT BULLETIN
FG-4

CIRCULAR TITSEAL® COPOLYMER FLAP GATES FLEXIBLE HINGE STYLE

- * Corrosion Resistant
- * Flexible Hinge
- * Lightweight
- * Adjustment Not Required
- * Quiet Operation

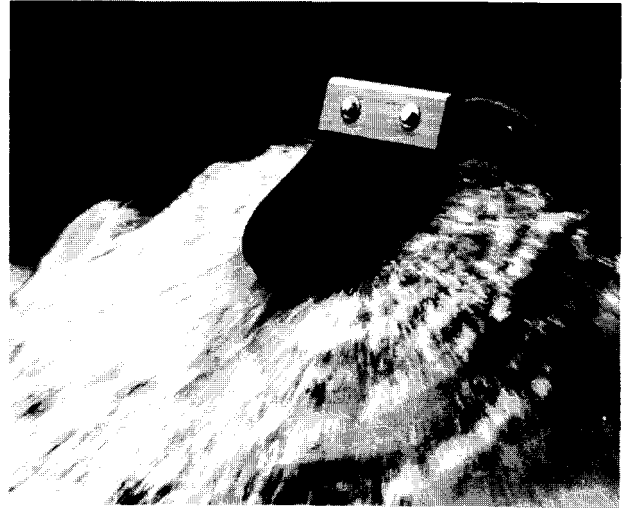

The Plasti-Fab, Inc. flexible rubber flap gate is the answer for applications requiring corrosion resistant equipment suitable for sea water and most low pH water. Simple construction and light weight make installation and maintenance easy.

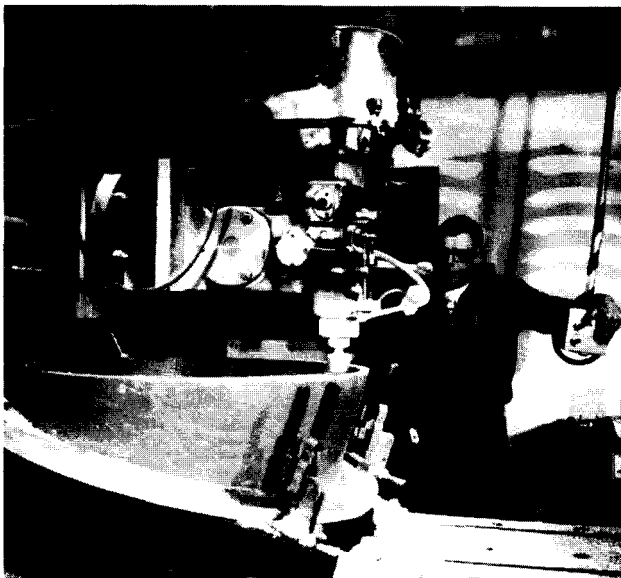

The molded body of reinforced copolymer has a 125 lb. pattern flange and a molded neoprene seal which also acts as a hinge. The flexible seal with molded-in weight reduces the possibility of pounding which is often a problem on valves having metal to metal seats.

Body flanges can be drilled to accept standard bolt sizes when connecting to pipe flanges or can be drilled for smaller bolts when they are to be fastened to wall thimbles or directly to wall surfaces.

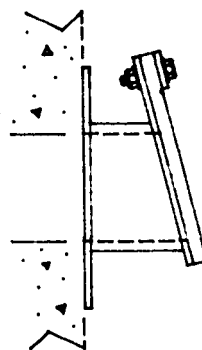

Wall mount

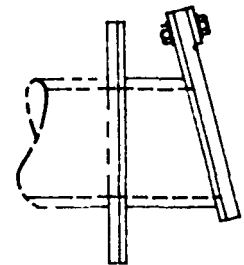

Flange mount

*We supply molded flappers to get the best quality possible. Rubber flappers larger than 14" are fabricated rather than molded. Our molded flapper encases the wafer weight and totally encapsulates the fabric reinforcing, producing a more durable flapper than is possible with calendared rubber sheet goods.

Rectangular and/or square flap gates having single or multiple flexible flaps are often supplied for specialized applications. Installations as large as 8 feet square are in service. Please see Plasti-Fab, Inc. bulletin on rectangular flap gates.

Installation and Periodic Cleaning:

Flap gates can trap floating debris and must be inspected periodically. They should, if possible, be mounted a foot or more above the surface of the downstream water to permit debris to clear the valve with the least resistance.

The surface to which the flap gate is to be attached should be flat, plumb, of sound material, and clean. A seal or heavy duty sealant must be used to prevent leakage past the flange. Care must be used when tightening bolts to assure a good seal and also to assure that the valve body is not distorted. When installing valves using poured-in-place anchor bolts, flanges must not be forced over crooked bolts -- drill out the flange for a good force-free fit.

Specifications:

Flap gates mounted on pipe ends shall be supplied with a 125 lb. pattern flange and mounted to the pipe using neoprene rubber gaskets and T-316 stainless steel bolts. The body of the flap gate shall be made of reinforced copolymer of a formulation suitable for the service intended.

The body of the valve (and wall thimble, if used) shall not be less than 1/4" thick for sizes 12" and smaller, and 1/2" thick for larger sizes. Wall thimbles (if used) shall have a rough coarse sand outer surface, a 3/16" thick waterstop, and shall be installed using suitable adhesive and non-shrink grout.

The rubber flap shall be made of 60 durometer molded neoprene, with a hinge suitably reinforced with encapsulated fabric to prevent any water from contacting the fabric (if a flapper of a compound other than neoprene is required, please specify). A weight shall be molded into the rubber to aid in proper quick closure and to prevent rubber distortion.

The rubber flap shall be held in place with a clamp bar and T-316 threaded fasteners no smaller than 5/16" diameter.

The rubber hinge/flap assembly shall be readily replaceable while the valve is in service.

Plasti-Fab, Inc. molded copolymer flap valve is the preferred flap valve for this installation.

P.O. Box 100
Tualatin, Oregon 97062
503/692-5460
FAX 503/692-1145

Plasti-Fab, INC.

